



**4 ft. x 8 ft. Folding Trailer
Owner's Manual
Model MFT4X8**

**8 ft. (244 cm)
Utility
Trailer**

DETAIL K2 INC.

1080 Clay Ave., Unit #2
Burlington Ont. L7L 0A1
1-888-277-6960



STOP!

Questions, problems, missing parts? Do not return to your retailer.

Please call our customer service department at: 1(888) 277-6960. Our customer service staff are ready to provide assistance. If a part is damaged or missing, replacement parts can be shipped from our facility. For immediate help with assembly, or for additional product information, call our North American toll-free number: 1(888) 277-6960.

Save this manual

You will need this manual for safety instructions, operating procedures, and warranty.
Put it and the original sales invoice in a safe, dry place for future reference.

ARRÊTEZ!

Vous avez des questions, des problèmes, ou des pièces manquent? Ne retournez pas chez votre détaillant.
Veuillez appeler notre service à la clientèle au: 1-888-277-6960. Notre personnel du service à la clientèle est prêt à vous fournir une assistance.

Si une pièce est endommagée ou manquante, une pièce de remplacement peut vous être expédiée rapidement de nos installations. Pour une aide immédiate à l'assemblage ou pour plus d'informations sur le produit, veuillez communiquer avec notre numéro sans frais 1-888-277-6960.

Conservez ce manuel

Ce manuel vous offre des instructions sur la sécurité, des procédures opérationnelles et votre garantie.
Gardez-le ainsi que votre facture originale dans un endroit sec et sécurisé pour référence future.

WARNING! Please read through these instructions completely **BEFORE** you begin to assemble and install your DK2 trailer. Failure to follow the instructions closely could cause serious personal injury or property damage.

Thank you very much for choosing a DK2 product! For further reference, please complete the owner's records below:

Model: _____ Purchase Date: _____

Save the receipt, warranty and these instructions. It is important that you read the entire manual to become familiar with this product before you begin using it.

This trailer is designed for certain applications only. The distributor cannot be responsible for issues arising from modification. We strongly recommend this trailer not be modified and/or used for any application other than that for which it was designed. If you have any questions relative to a particular application, **DO NOT** use the trailer until you have first contacted the distributor to determine if it can or should be performed on it.

TABLE OF CONTENTS

Important safe operating practices	3
General warnings	4
Specific operation warnings.....	4
Contents	5
Technical specifications	5
General warnings	5
Bed assembly	7
Drawbar assembly	8
Spring hanger assembly.....	9
Fender kit assembly	10
Spring and axle assembly	11
Tire assembly	12
Lighting kit installation	14
Wiring the trailer	15
Attaching the coupler.....	18
Safe use and operation rules.....	20
Towing vehicle	20
Hitch, ball, coupler.....	20
Safety chains	20
Loading.....	20
Lighting	20
Wheels and tires.....	21
Operation.....	21
Folding the trailer.....	21
Maintenance	22
Canadian trailer licensing notice	23
U.S.A trailer licensing notice	23
Licensing	23
Parts List.....	24
Schematic diagram.....	25

IMPORTANT SAFE OPERATING PRACTICES

IMPORTANT: *Read safety rules and instructions carefully before using this equipment. Read and follow instructions carefully. Save owner's manual for future reference or parts information. Be certain any future user of this carrier is aware of correct attachment and use.*

CAUTION: *Safety First — Read this manual carefully before attaching and using your trailer. We recommend that you read this manual completely so that you are fully aware of all important safety recommendations. Record your serial number.*

DANGER: *This equipment was built to be operated according to the rules for safe operation in this manual. As with any type of equipment, carelessness or error on the part of the operator can result in serious injury or property damage.*

- To use this equipment properly, you must observe the safety regulations, the assembly instructions and the operating instructions to be found in this manual.
- All persons who use and service the trailer must be informed about potential hazards and must be well acquainted with this manual.

IMPORTANT WARNING: *It is critical that your DK2 Trailer is properly secured to the vehicle.*

- *Attaching it improperly could result in a vehicular accident, causing serious bodily harm, injuries, or death to you or to others.*
- *Securing trailers and accessories to your vehicle is your legal responsibility. Check the trailer prior to use, and inspect the components for adjustment, wear, and damage periodically.*
- *You must read and understand all of the instructions and cautions before you install or use the trailer.*
- *If you do not understand all of the instructions and cautions, or if your mechanical experience precludes following them, have the trailer installed by a professional.*

WARNING: *You are responsible to ensure the trailer attaches safely and securely to the vehicle.*

- *This trailer is designed for use on passenger cars, trucks, and SUVs that have the trailer hitch and weight capacity.*
 - *Inappropriate use and fastening of the trailer to the vehicle may lead to damage to cargo, the trailer, and/or your vehicle. It may also inflict damage on other vehicles behind and elsewhere on the road with you.*
- Do not take the trailer through an automatic car wash.

GENERAL WARNINGS

WARNING: *Read and understand all instructions. Failure to follow all instructions listed below may result in electric shock, fire and/or serious injury.*

WARNING: *The warnings, cautions, and instructions discussed in this instruction manual cannot cover all possible conditions or situations that could occur. It must be understood by the operator that common sense and caution are factors that cannot be built into this product, but must be supplied by the operator.*

1. **KEEP THE WORK AREA CLEAN AND DRY.** Damp or wet work areas can result in injury.
2. **KEEP CHILDREN AWAY FROM WORK AREA.** Do not allow children to handle this product.
3. **ALWAYS WEAR ANSI-APPROVED SAFETY GLASSES AND HEAVY-DUTY WORK GLOVES** during assembly and use. Do not wear loose clothing or jewelry which can get caught in moving parts.
4. **READ YOUR OWNER'S MANUAL CAREFULLY.** Get to know your trailer and familiarize yourself with its applications and limitations.
5. **USE THE TRAILER ACCORDING TO THE GUIDELINES IN THIS MANUAL.** Do not abuse it or force it to do a job for which it was not designed.
6. **USE ONLY ORIGINAL EQUIPMENT PARTS AND ACCESSORIES.** Consult this owner's manual. The use of incorrect accessories may produce unforeseen hazards.
7. **STORE IDLE EQUIPMENT.** When not in use, tools and equipment should be stored in a dry location to inhibit rust. Always lock up tools and equipment, and keep out of reach of children.
8. **USE THE RIGHT TOOL FOR THE JOB.** Do not attempt to force small equipment to do the work of larger industrial equipment. There are certain applications for which this equipment was designed. It will do the job better and more safely at the capacity for which it was intended. Do not modify this equipment, and do not use this equipment for a purpose for which it was not intended.
9. **CHECK FOR DAMAGED PARTS.** Before using this product, carefully check that it will operate properly and perform its intended function. Check for damaged parts and any other conditions that may affect the operation of this product. Replace damaged or worn parts immediately.
10. **DO NOT OVERREACH.** Keep proper footing and balance at all times to prevent tripping falling, back injury, etc.
11. **DO NOT USE THIS TRAILER WHEN TIRED OR DISTRACTED.**
12. **INDUSTRIAL APPLICATIONS MUST FOLLOW OSHA REQUIREMENTS.**

SPECIFIC OPERATION WARNINGS

1. **BEFORE EACH USE, ALWAYS EXAMINE THE TRAILER** for proper tire (13) condition and air pressure, damaged Tail Lights (30L, 30R), damaged Side Running Lights (38), loose bolts and nuts, structural cracks, bends and any other condition that may affect its safe operation. Do not use the Trailer even if minor damage appears.
2. **BEFORE EACH USE, ALWAYS ATTACH THE SAFETY CHAINS** (1) of the trailer to the towing vehicle. Make sure the Safety Chains are attached to the towing vehicle with an equal length at each side. Do not allow the Safety Chains to drag on the ground.
3. **ALWAYS CHECK TO MAKE SURE THE PAYLOAD BEING TRANSPORTED IS PROPERLY AND SAFELY SECURED IN THE TRAILER.** Load the trailer evenly from side to side with 60% of the load weight forward of the Axle (7).
4. **MAKE SURE THE TOWING VEHICLE IS CAPABLE OF TOWING THIS TRAILER AND ITS PAYLOAD.** Make sure the hitch on the towing vehicle is capable of towing the trailer and its payload. The towing

GENERAL WARNINGS

- capacity of the hitch is typically stamped on the hitch drawbar.
5. **MAKE SURE** the hitch coupler (7) and the vehicle's Ball Hitch (not included) are of equal mating size (2") and are rated equal to or greater than the weight of the trailer and its payload.
 6. **DO NOT EXCEED 45 MILES PER HOUR (72 km/h)** when towing the trailer. Excess speed is a major cause of vehicle-trailer accidents.
 7. **DO NOT ATTEMPT TO POWER THE TRAILER LIGHTS WITH ANY OTHER THAN THE CORRECT TYPE OR VOLTAGE ELECTRICAL CURRENT.** The LED tail lights supplied with this trailer are for a 12 volt DC electrical system only.
 8. **PARK THE TRAILERS ON A FLAT, LEVEL, PAVED SURFACE AND CHOCK BOTH TIRES** whenever possible, to keep the trailer from accidentally moving.
 9. **BEFORE ATTEMPTING TO FOLD UP THE TRAILER,** make sure it is on a flat, level, solid surface and chock both Tires (13).
 10. **NEVER ATTEMPT TO FOLD UP THE TRAILER WITHOUT THE HELP** of one or two able assistants.
 11. **DO NOT EXCEED THE 1450 POUND WEIGHT CAPACITY.**
 12. **DO NOT ALLOW ANYONE TO RIDE** in a towed vehicle or on the trailer.
 13. **DO NOT TRANSPORT PASSENGERS OR HEAVY CARGO INSIDE A VEHICLE** that is being towed.
 14. **THE COUPLER MUST BE PROPERLY SECURED TO THE HITCH BALL.** After assembly and attachment, pull up and down on the hitch coupler to make sure the hitch ball is snug in the hitch coupler. If the coupler is not secured properly, it could come loose while the trailer is in motion, causing property damage, serious personal injury or even death.
 15. **MAKE WIDE TURNS** when towing a loaded trailer, avoiding both sharp turns and U-turns. Turning too sharply can cause damage to the trailer and/or the tow vehicle.

UNPACKING

- When unpacking, check to make sure all the parts shown on the Parts List (see p.) are included.
- If any parts are missing or broken, please contact with us.

TECHNICAL SPECIFICATIONS

Tires	5.30-12 tubeless
Wheel Lug Nuts	5 per wheel: 85-90 ft-lb. (115.24 - 122.02 Nm) torque
Tire Pressure	80 PSI (552 kPa) cold
Rim	12 x 5
Bed Dimensions	4 ft. x 8 ft. (1.22 m x 2.44 m)
Ball/Coupler size	2 Inch (≈ 50 mm)
Coupler capacity	Class II; 3500 lb. (1587.6 kg), Maximum Gross Load
Load Capacity	1450 lb. (657.7 kg)
Net weight	262 lb. (118.8 kg)
GAWR	1980 lb. with 5.30-12 tires at 80 PSI cold
GVWR	1720 lb.

ASSEMBLY

Read the following instructions step by step. Refer also to the complete parts and hardware list.

Average assembly time is 1 hour.

You will need the following tools to assemble your trailer:

16 mm wrench or socket

17 mm wrench or socket

18 mm wrench or socket

19 mm wrench or socket

20 mm wrench or socket

21 mm wrench or socket

Pliers

Phillips screwdriver

Rubber mallet

NOTE:

- *The trailer parts are called out by standing at the rear of the trailer looking toward the hitch. The trailer frame parts are labeled.*
 - *Do not tighten any nuts and bolts until the entire trailer is assembled.*
 - *Periodically check all the nuts and bolts for tightness.*
 - *Tighten the wheel lug nuts to 85-90 ft-lb. (115.24 - 122.02 Nm) of torque after assembling the trailer, after the first 20, 50 and 100 miles (30, 80, and 160 kilometres) of driving and before each tow thereafter.*
-
-

ASSEMBLY

STEP 1

BED ASSEMBLY

Lay the front bed (26) and rear bed (21) as shown. Note the location of the marker lights holes in the front side rails. See fig.1

1. Use M10 x 20 hex head bolts and nuts (34) to mount the 8 stake pockets (40) to the trailer as shown.
2. Use M10 x 20 hex head bolts and nuts (34) to mount the inside hinge (27) to the front bed (26) and the outside hinge (28) to the rear bed (31);

NOTE: Do not join the hinges from front to rear bed halves yet.

3. Keep the two center M10 x 20 hex head bolts and nuts (34) to connect the bed halves aside until you are ready to join the bed halves and make the trailer one solid deck.

NOTE: Do not join the bed halves until later in the assembly process, set the rear bed half aside for later in the assembly.

Item N°.	Description	Qty
34	Hex M10 x 20 & nut (set)	28
40	Stake pocket	8
28	Outside hinge	2
27	Inside hinge	2

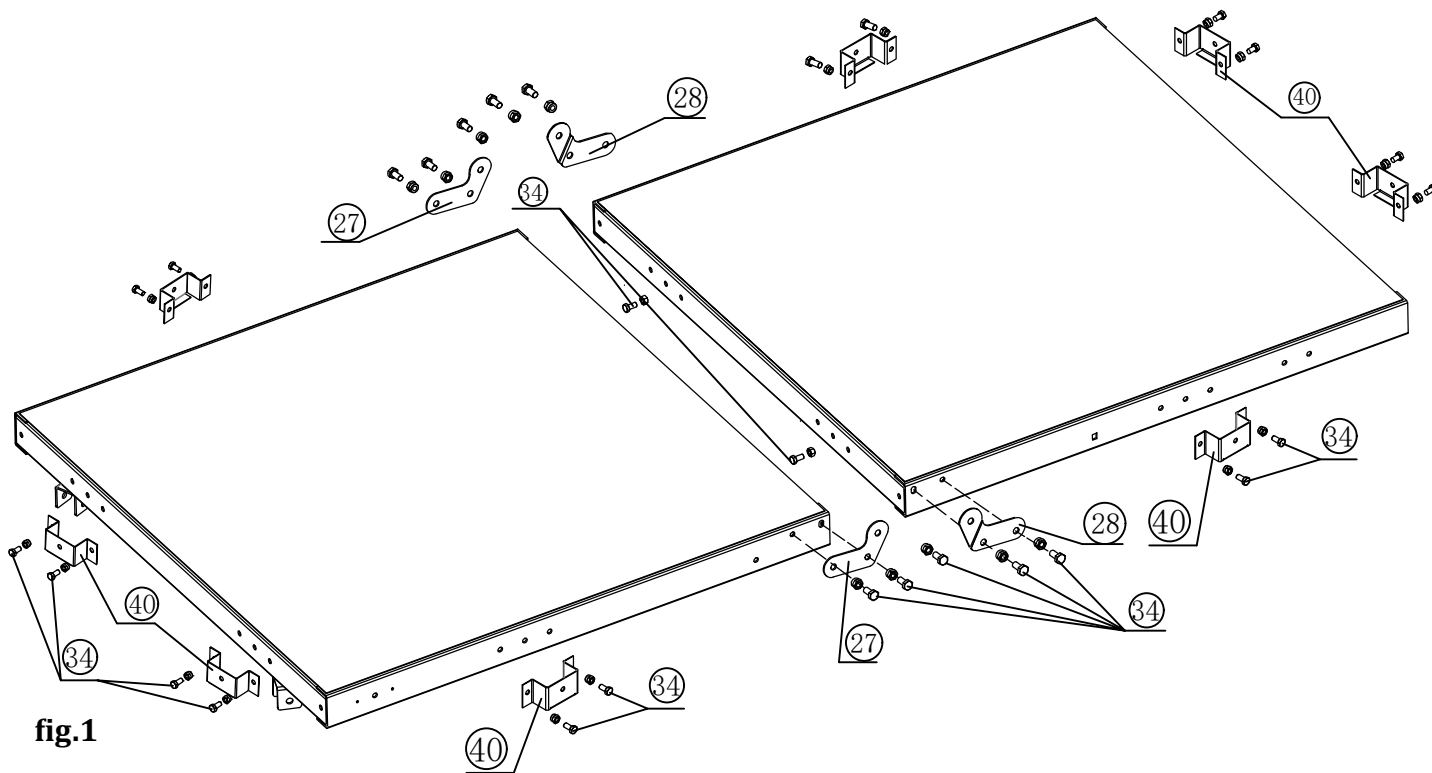

ASSEMBLY

STEP 2

DRAWBAR ASSEMBLY

ENGLISH

1. Flip the front bed half over so it is upside down.
2. Position drawbar (5L, 5R) to the trailer front bed (26), fitting the bars into the U slots on the front cross member.
3. Use L latch (37) to go through the U bracket and lock with R clip after then.
4. Use M10 x 30 (36), M12 x 25 (39) to connect the drawbar end to trailer side rails. Do not tighten the bolts until all bolts in position.
5. Connecting drawbar T plate (3), drawbar coupler base (4) as shown with M10 x 20 (34)

Item N°.	Description	Qty.
3	Tow bar T-plate	1
4	Coupler base	1
5	Tow bar	2
34	Hex M10 x 20 bolt & nut (set)	12

Item N°.	Description	Qty.
36	Hex bolt M10 x 30 & nut (set)	2
37	Hitch pin Ø12 x 75 & R clip (set)	2
39	Hex bolt M12 x 25 & nut (set)	2

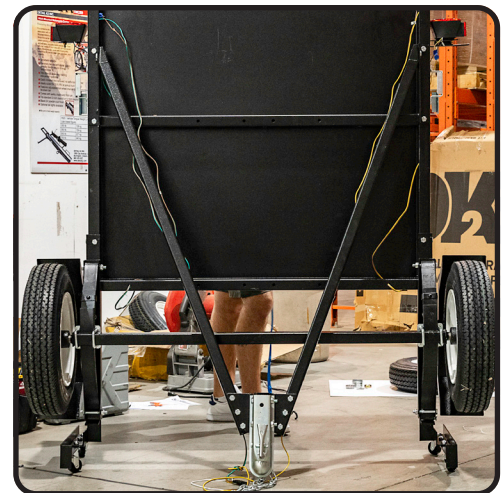
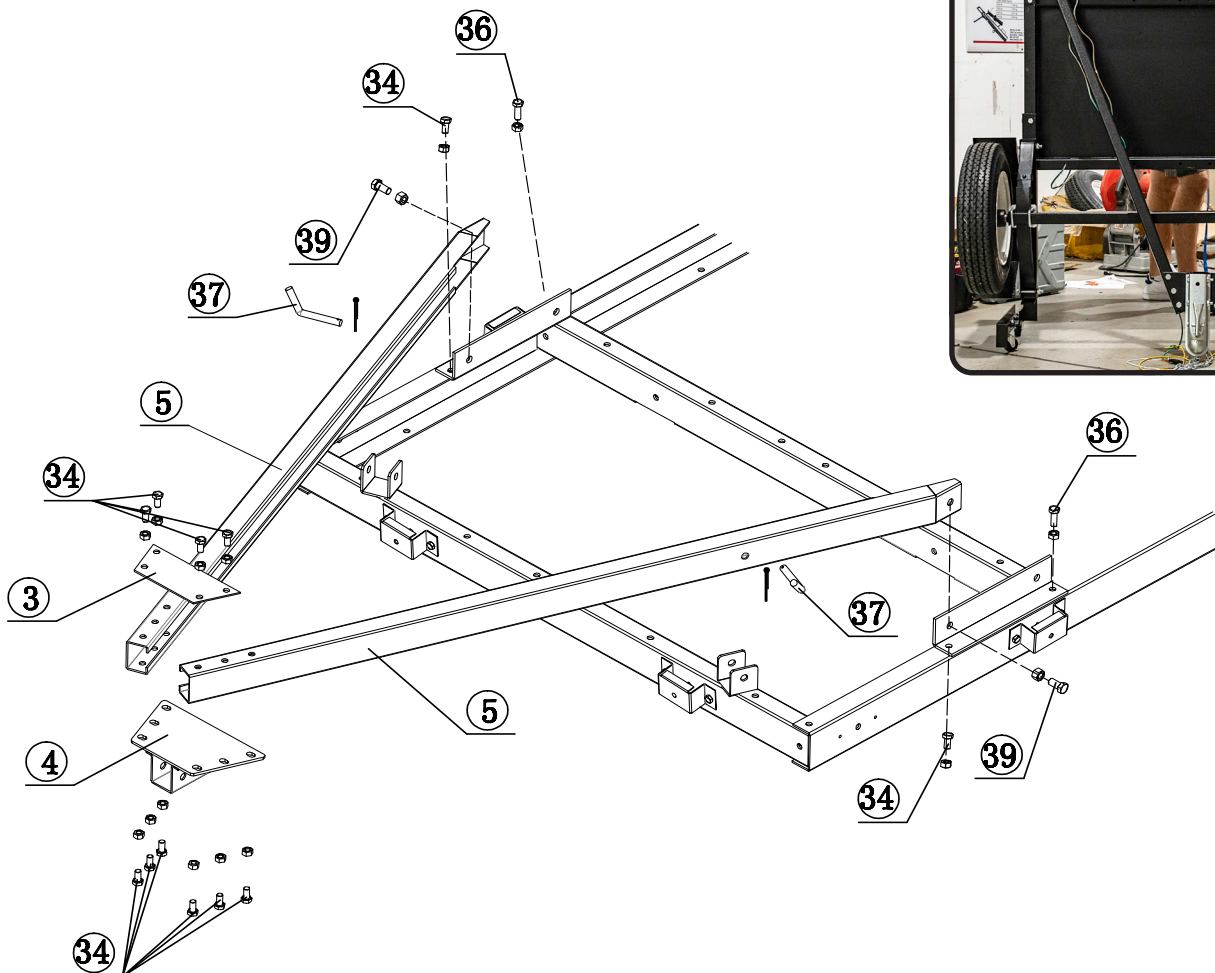

fig.2

ASSEMBLY

STEP 3

SPRING HANGER ASSEMBLY

Install the Left spring hanger (19) and Right spring hanger (shown, 41, fig.3) to trailer sides with M10 x 20 (34) at front, M10 x 30 (36) in the middle and M10 x 25 carriage bolts (35) for rear end.

(35) insert finger tight for later in the assembly process, this will secure your bed halves

Item N°.	Description	Qty.
19	Left spring hanger	1
34	Hex bolt M10 x 20 & nut (set)	4
35	Carriage bolt M10 x 25 & nut (set)	4
36	Hex M10 x 30 bolt & nut (set)	2
41	Right spring hanger	1

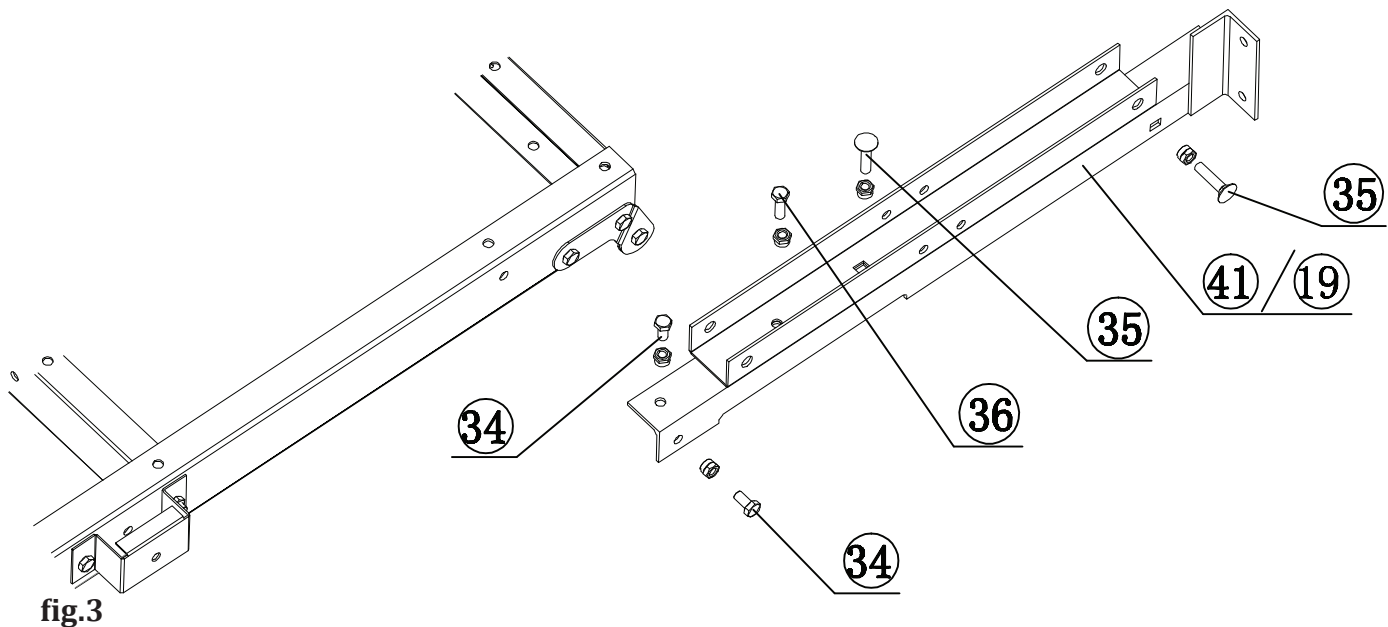

ASSEMBLY

STEP 4

FENDER KIT ASSEMBLY

ENGLISH

NOTE: You will have to prop up the bed to give yourself space to attach fender and caster bracket.

1. Connect the fender bracket (24) to spring hangers (19,41) with M10 x 20 bolts and nuts (34).
2. Connect fender (25) to fender bracket with M10 x 20 (34). Note that the holes on the side of the fender edge are toward the trailer.
3. Connect left caster bracket (22) to left spring hanger (19). Connect Right caster bracket (23) to the right spring hanger(41).
4. Install the caster (21) to the caster brackets.



Item N°.	Description	Qty.
21	Caster	4
22	Left caster bracket	1
23	Right caster bracket	1
24	Fender bracket	2
25	Fender	2
34	Hex bolt M10 x 20 & nut (set)	12

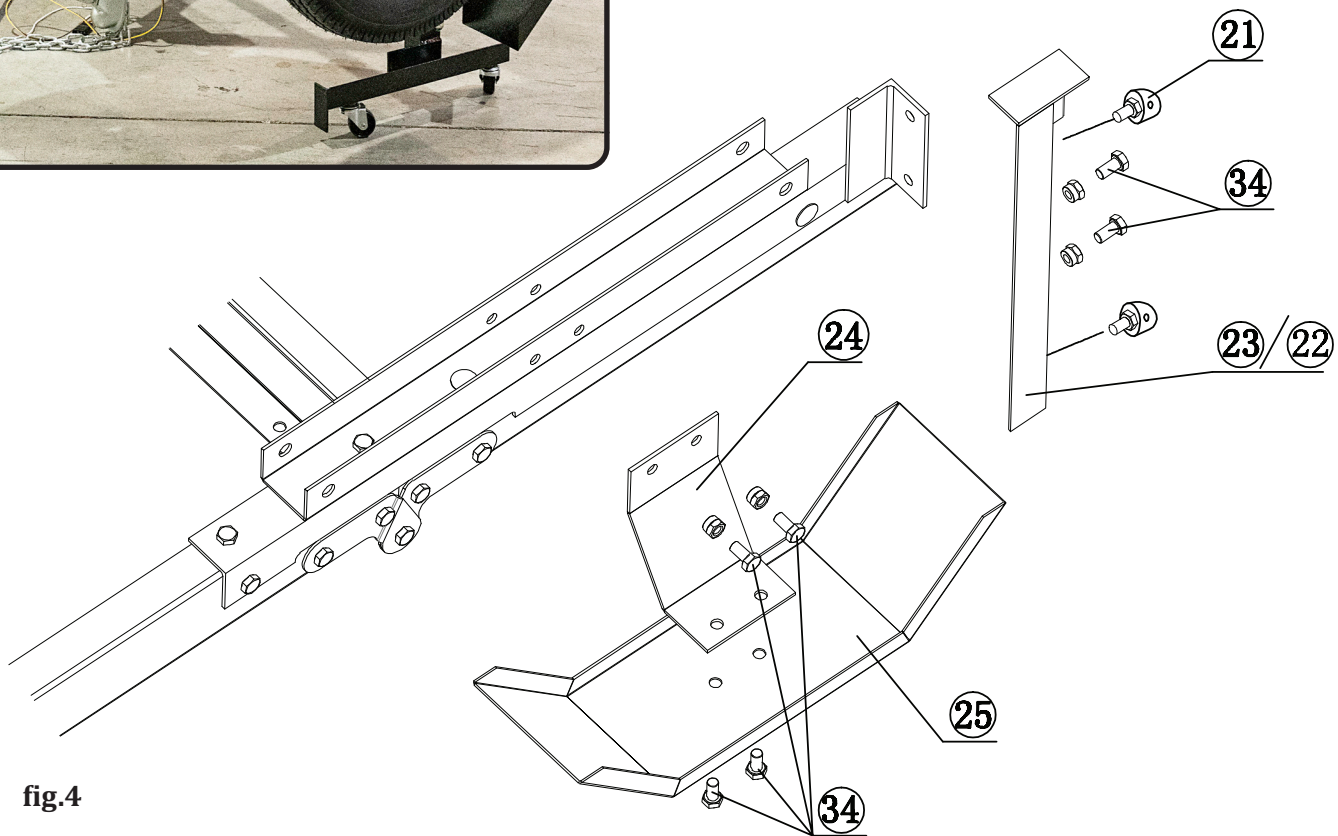

fig.4

ASSEMBLY

STEP 5

SPRING AND AXLE ASSEMBLY

1. Place 3 leaf spring (8) into spring hanger with eye forward, towards the drawbar of the trailer. Install M14 x 85 (9) go through spring hanger, and spring eye and lock with M14 nyloc nut.
2. Install M14 x 85 go through spring tail and spring hangers and lock with M14 nyloc nut.
3. Place Axle (7) onto spring (8) with hole in axle over peg on spring. Fasten Axle to **each** spring with two U bolts (9), spring plate (6) and lock with four M10 nuts as shown.

Item N°.	Description	Qty.
6	Spring plate	2
7	Axle	1
8	3-leaf spring	2
9	U-bolt M10 x 85 & nuts (set)	4
20	Hex bolt M14 x 85 & nyloc nut (set)	4

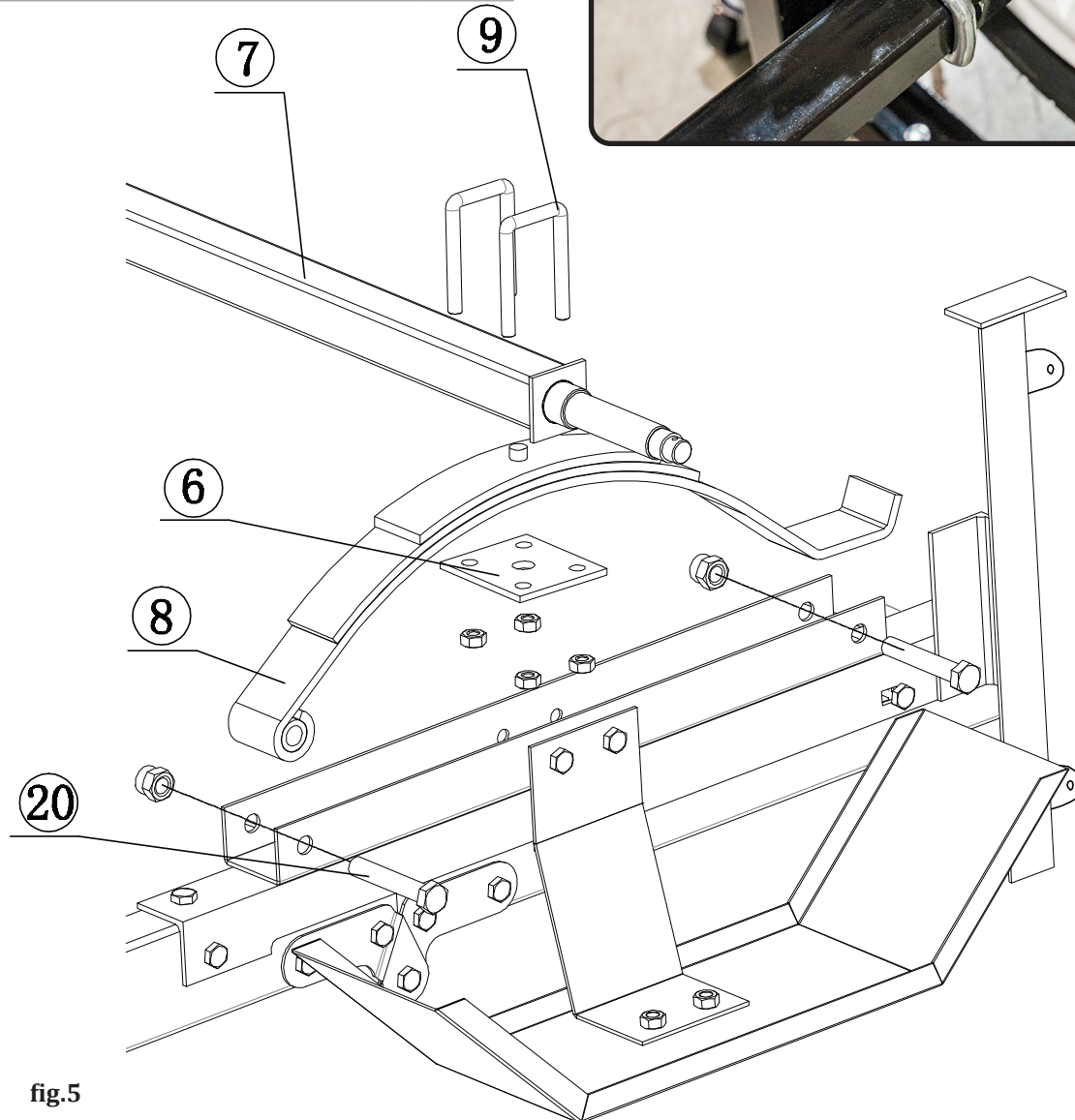
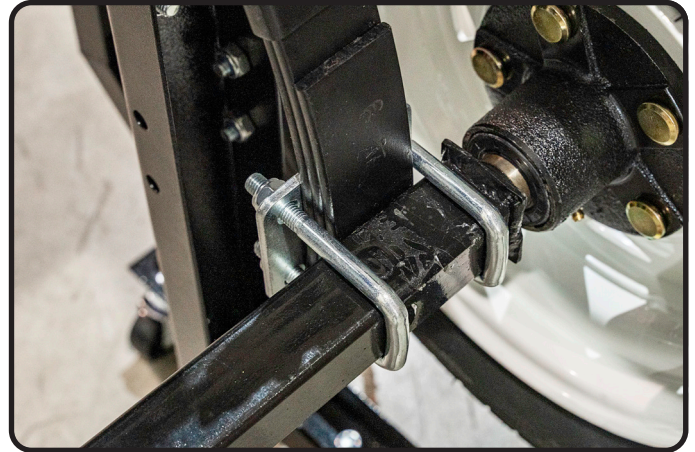

fig.5

ASSEMBLY

STEP 6

TIRE ASSEMBLY

ENGLISH

1. Locate both tire/hub assemblies. For easy access, be certain that grease fittings are facing out away from the hub as shown in figure 6-1.
2. Remove hubcap (21) using a small pry bar between the flange on the hub cap and the face of the hub (fig.6-2a).
3. Remove 4 mm cotter pin (L), bearing (20) and washer (N). See figure 6-2b.
4. Remove castle nuts (H) from axle ends.

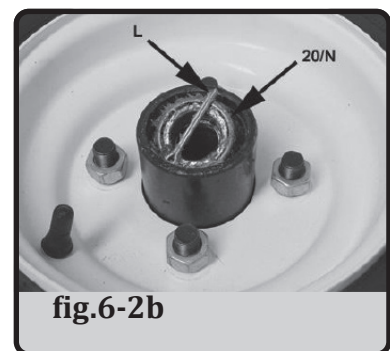
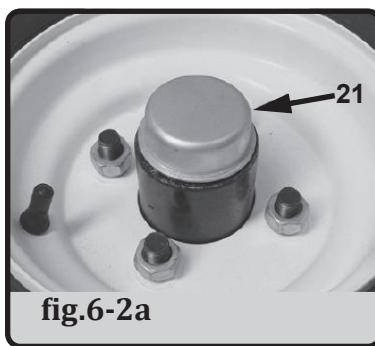

5. Carefully slide tire/hub assembly onto axle with lug nuts facing outward. See fig. 6-3

Item N°.	Description	Qty.
11	Bearing	2
12	Hub assembly	2
13	Tire and rim	2
14	Washer M22	2
15	Castle nut M22 x 1.5	2
16	Cotter pin	2
17	Lug nut	10
18	Dustcap	2

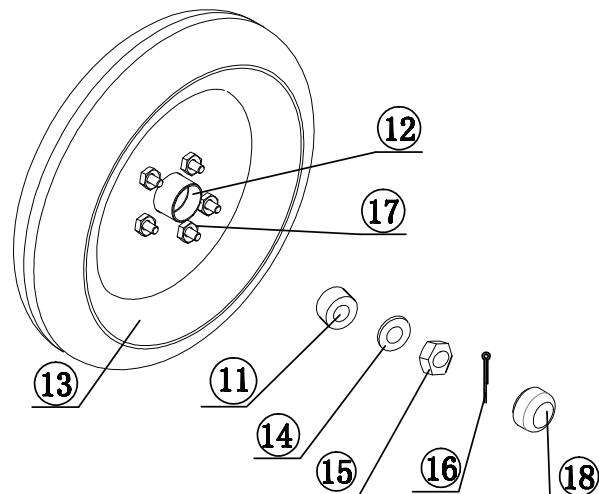
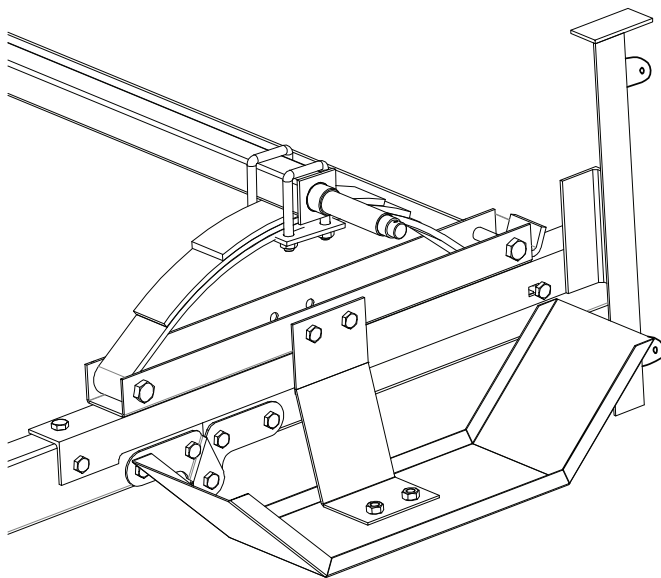

ASSEMBLY

6. Install outer bearing (fig.6-3, 11) with the taper facing inward toward the hub.
7. Install the washer and castle nut (fig.6-3, 14 & 15). Tighten castle nut while turning the tire/hub. Tighten castle nut until there is resistance while turning the tire/hub.
8. Install 4 mm cotter pin (fig.6-4, L) through castle nut (fig.6-4, H) and hole in axle end. If holes are not aligned, slightly loosen castle nut -no more than one castellation- to align holes.
9. Spread cotter pin (L) to retain castle nut. See figure 6-4.
10. Pump approximately 8-10 pumps of a hand grease gun into hub.
11. Install hub dustcap (fig.6-5, 21) firmly on hub with rubber mallet.
12. Repeat steps 2-11 for the other tire/hub.
13. While the trailer is still upside down on the ground, move to installing the wiring.

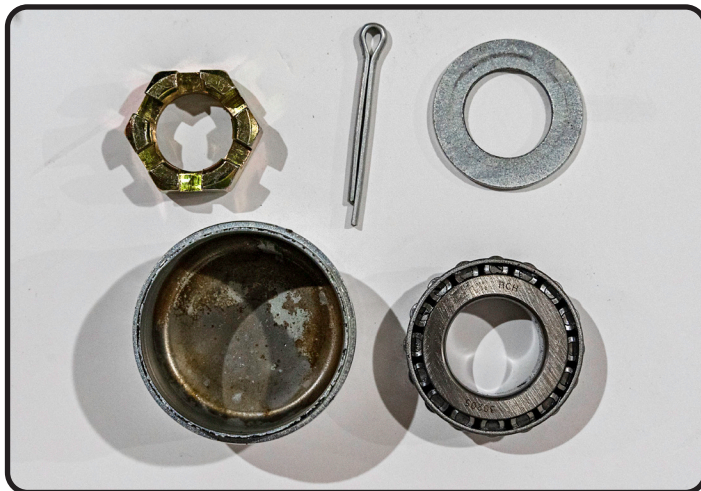
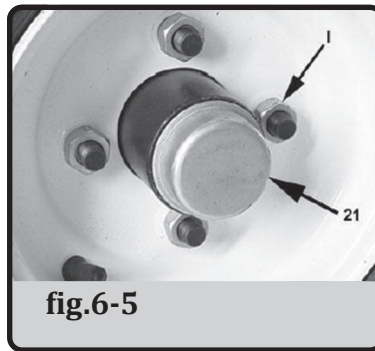
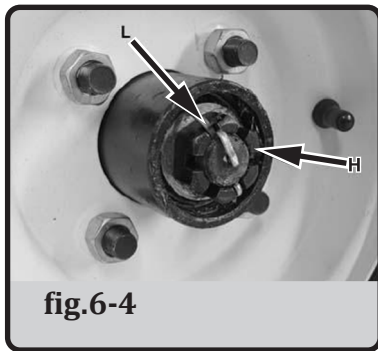

ASSEMBLY

STEP 7

GETTING YOUR TRAILER TOW READY

1. Lay the rear bed upside down on the front trailer bed
2. Fasten the brackets together using the M10 x 20 (34) on both sides
3. Carefully flip the rear trailer bed down as shown in fig. 7-1

NOTE: two (35) and two (34) can be inserted to join your bed halves and have your trailer tow ready.

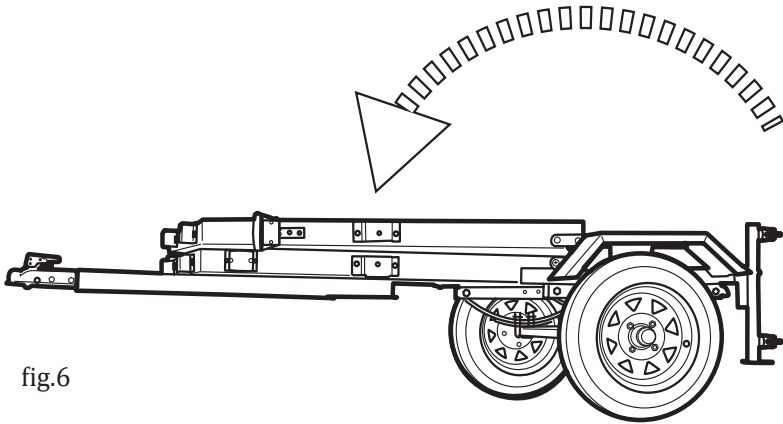

fig.6

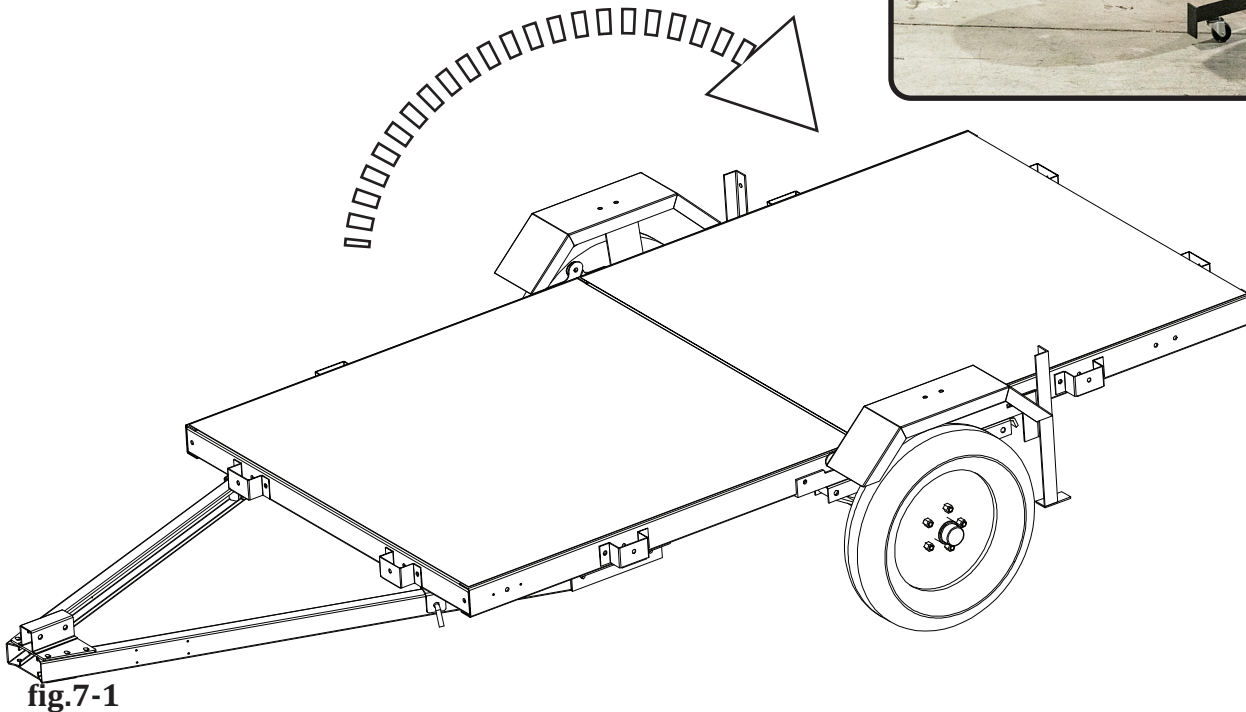

fig.7-1

ASSEMBLY

STEP 8

LIGHTING KIT INSTALLATION

1. Attach the Light Brackets (33) to the Rear Left Side Rail and Rear Right Side Rail by using four sets of M10 x 20 Bolts and M10 Nuts (44).
2. Attach the License Plate Bracket (29) with the Left Tail Light (30L) to the Light Bracket on the Rear Left Side Rail, using M10 Nuts.
3. Attach the Right Tail Light (30R) to the Light Bracket on the Rear Right Side Rail, using M10 Nuts.
4. Attach the Side Running Light to the Front Left Side Rail, using 4 mm Self-Tapping Screws from the light package.

NOTE: The trailer should be, at this point, upside down. Fig.7 shows the position of the lighting components on a right-side up trailer for clarity.

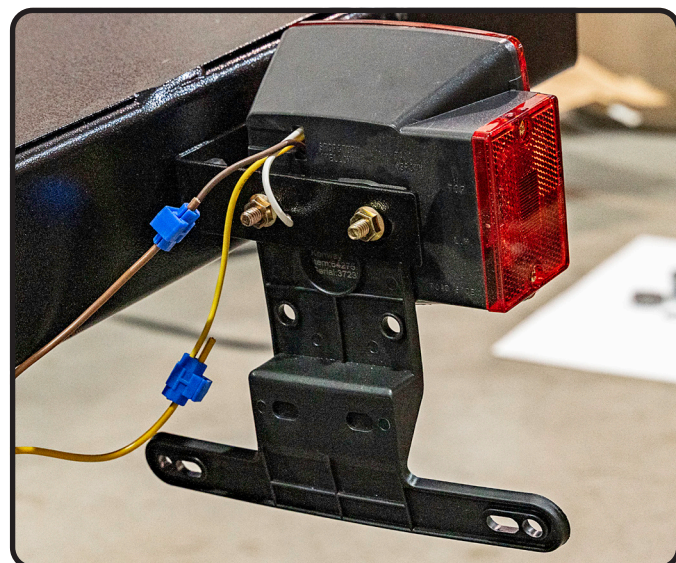

Item N°	Description	Qty.
29	Licence holder	1
30	Rear light	2
33	Light bracket	2
34	Hex bolt M10 x 20 & nut (set)	4
38	Side marker	2

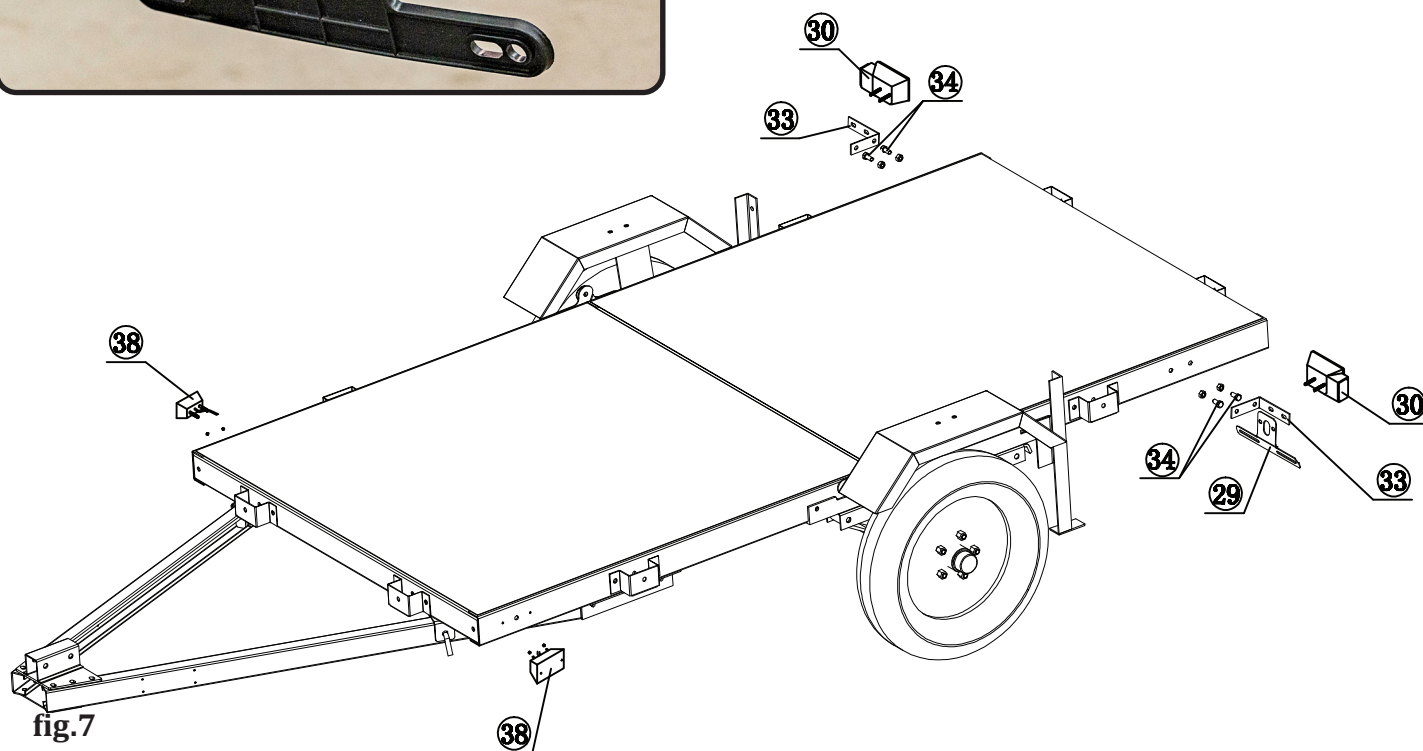

fig.7

ASSEMBLY

STEP 9

WIRING THE TRAILER

NOTE: Only a qualified technician should perform the electrical service that may be needed to enable your particular make/model vehicle to power the Trailer's 12 volt DC lighting system. This is beyond the scope of this manual.

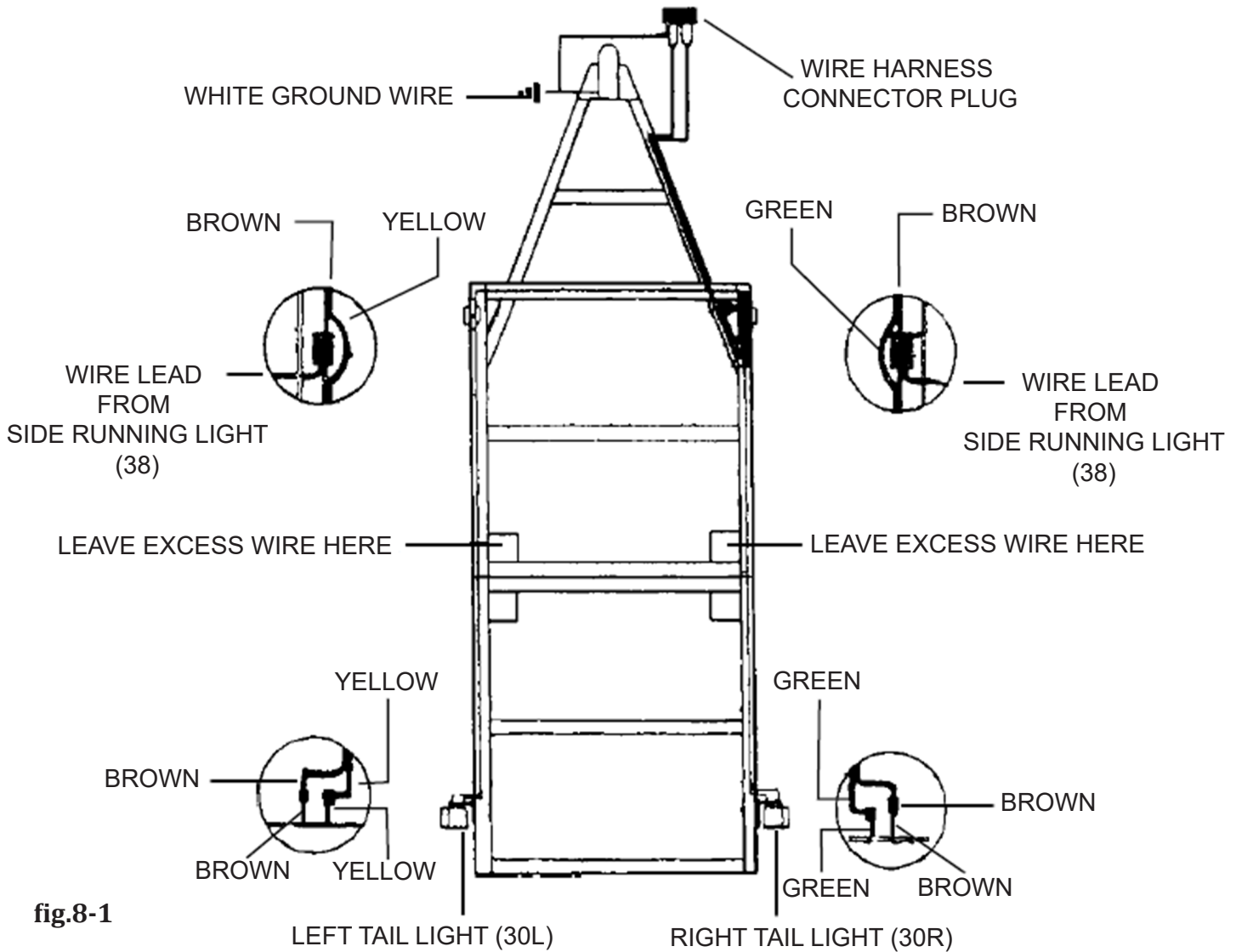
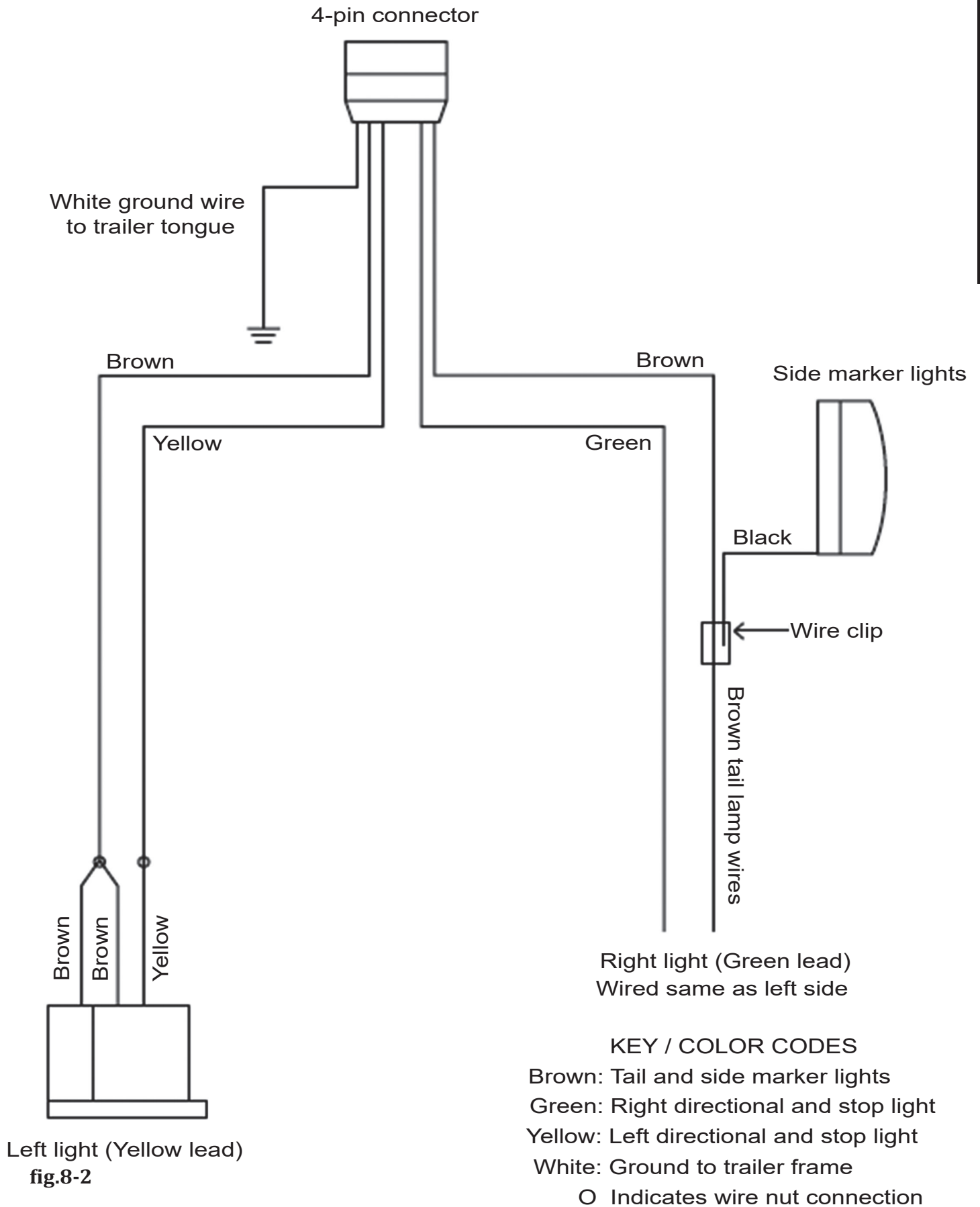

fig.8-1

1. Have a qualified service technician install a 4-wire, 12 VDC connector in the trunk area of your vehicle.
2. Locate the vehicle's connector plug near the Trailer's Coupler (2) and lay out the Trailer's wiring harness wires.

NOTE: fig.8-1 and 8-2 show the trailer right side up. Keep in mind, the trailer is actually upside down at this point to make wiring installation easier, so the left and right sides appear reversed.

ASSEMBLY



Left light (Yellow lead)
fig.8-2

ASSEMBLY

3. Connect the brown wire to the vehicle's left tail light by stripping, wrapping, and taping the connector plug.
4. Connect the yellow wire to the vehicle's left signal and stop light wire.
5. Connect the green wire to the vehicle's right signal and stop light wire.
6. Attach the white ground wire at the plug end of the wiring harness to the small mounting hole in the Tow Bar (5) with a 1/4" (6 mm) tapping screw (not included).
See J, fig.8-3.

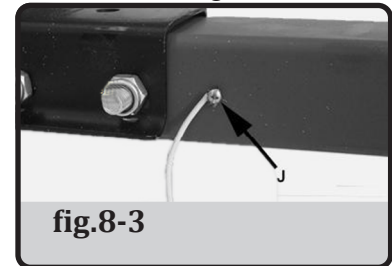

7. Run the yellow/brown wires along the inside of the Front Cross Member (39) to the Side Running Light (38) on the Front Left Side Rail (26).
8. Run the green/brown wires along the inside of the Front Right Side Rail to the other Side Running Light.
9. Connect the wire lead from the two Side Running Lights to the brown wire on each side of the trailer, using wire connectors. Then insert wire clips along the entire length of the side rails of the Trailer to hold down the wiring harness.
10. Run the yellow/brown wires to the Left Tail Light (30L), leaving some excess wire where the frame folds.
11. Strip approximately 3/4" (19 mm) of insulation off the ends of the wires.
12. Connect the yellow wire to the yellow wire of the Left Tail Light.
13. Connect the brown wire to the brown wire of the Left Tail Light.
14. Run the green/brown wires to the Right Tail Light (30R), leaving some excess wire where the frame folds.
15. Strip approximately 3/4" (19 mm) of insulation off the ends of the wires.
16. Connect the green wire to the green wire of the Right Tail Light.
17. Connect the brown wire to the brown wire of the Right Tail Light.

NOTE: Use dielectric grease on each connector for corrosion prevention

18. Turn over the whole trailer assembly so the tires touch the ground.
-

CAUTION! Make sure you get the assistance of 1 or 2 additional people. Do not try this on your own.

19. Even though the wheels were already mounted to the hubs, you **must** tighten all the lug nuts (I) to 85-90 lb/ft of torque.

ASSEMBLY

STEP 10

ATTACHING THE COUPLER

1. Attach the Coupler (2) to the Coupler Base (4), using two sets of M12 x 75 bolts (20b) and M12 nuts (20n). When installing the front bolt, thread it through the center link of the Safety Chain (1) to secure the Chain to the Coupler.

Item N ^o .	Description	Qty.
1	Safety chain	1
2	2 inch coupler	1
20	Hex bolt M12 x 80 & nut (set)	2

Pin and R-Clip.

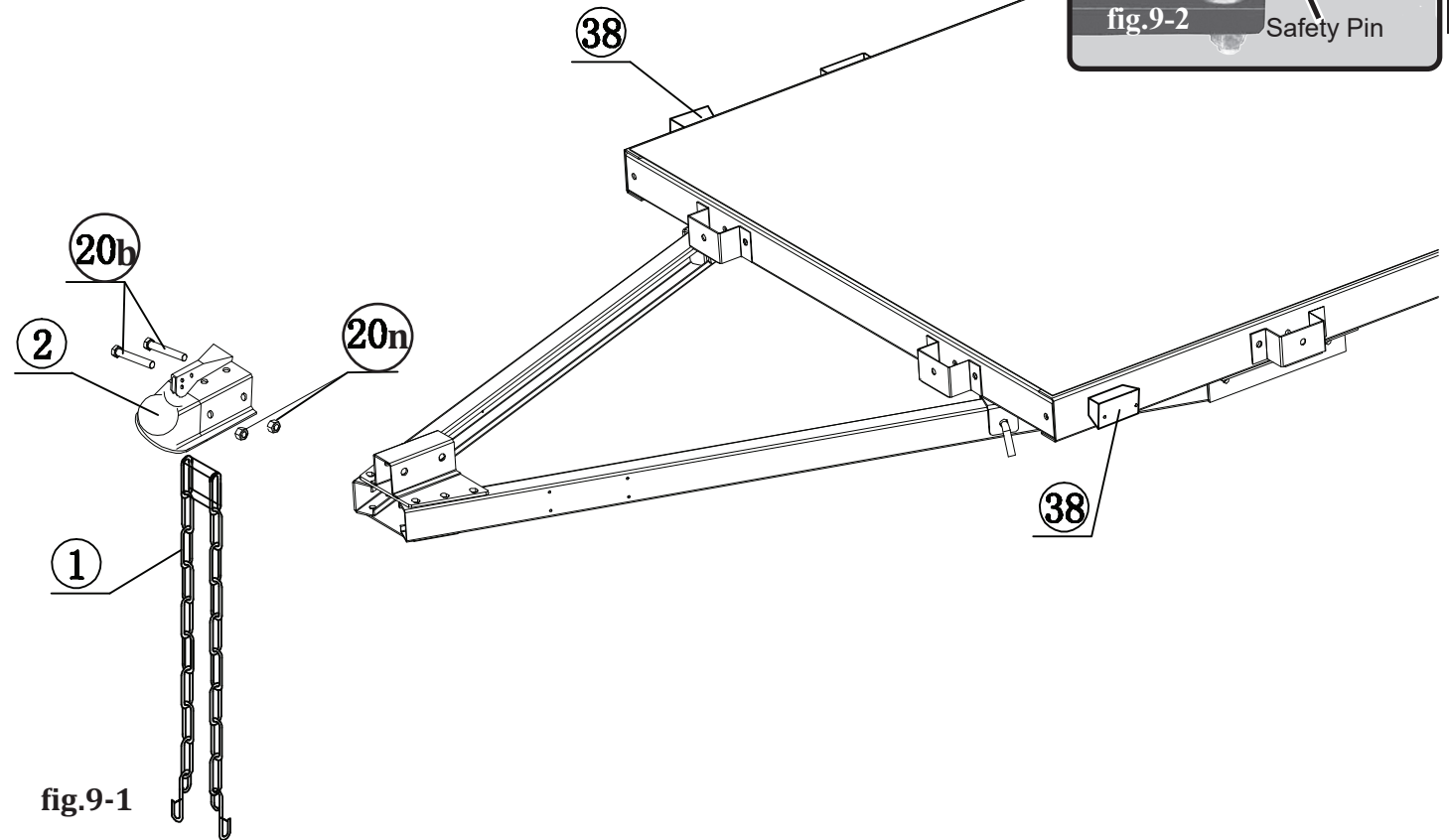
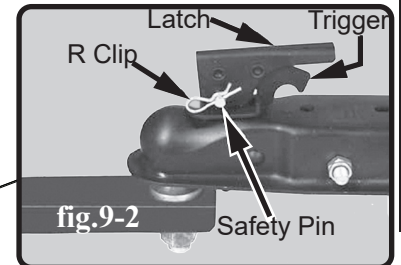

3. Pull up and down on the coupler to see if the coupler is fitting snug on the ball. There must not be play between the ball and coupler. If there is play, tighten the adjustment nut until no play is present. If the nut is too tight, the handle will not lock.

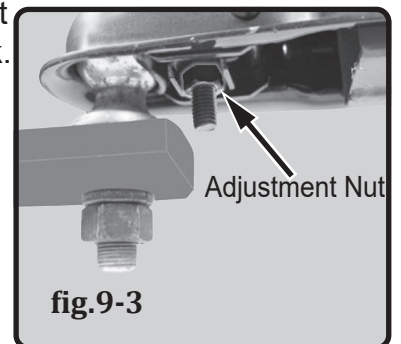
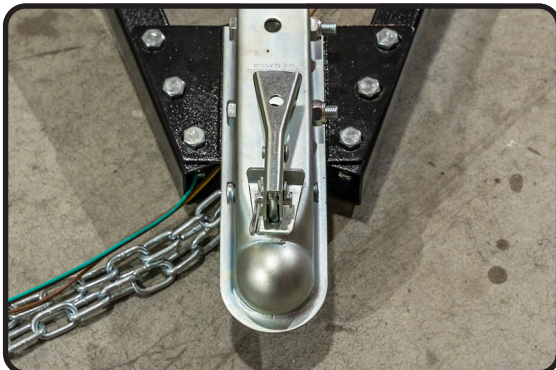

ASSEMBLY

WARNING! Risk of trailer uncoupling.

- The coupler provided with your trailer requires a 2 inch hitch ball.
- Use only a 2 inch hitch ball on the tow vehicle towing this trailer

NOTE: To reduce friction between the ball hitch and coupler, apply a layer of multipurpose lithium grease over ball hitch. Wipe off excess grease when not in use to avoid staining clothes.

Assembly is complete



SAFE USE AND OPERATION RULES

TOWING VEHICLE

- Make sure vehicle is capable of towing the load.
- Excess speed is the second most important cause of car-trailer accidents. Recommended maximum speed for all passenger cars towing trailers is 45 mph (72 km/h).

HITCH, BALL, COUPLER

- Check that the hitch on the towing vehicle is capable of towing the trailer. The capability of the hitch is normally stamped on the hitch bar and the capacity of the ball is stamped on the ball.
- Make sure the coupler and the ball the same size and are rated equal to or greater than the load.
- Never attach anything other than the proper size coupler to the ball for towing.

SAFETY CHAINS

- Always cross the chains under the coupler and connect the safety chains to the tow vehicle frame.
- Check that safety chains are attached to towing vehicle with the same length for each side.
- Do not allow chains to drag on ground.

LOADING

- Never overload trailer. Maximum load is 1450 pounds (657.7 kg).
- Load trailer evenly from side to side with 60% of the load forward of the axle. It is important that the tongue be pressing down on the hitch, but not exceeding a downward force of 90 pounds (40.8 kg).
- Reduce weight in car trunk and rear seat areas by amount of tongue weight of your trailer.
- It is unsafe and also against the law to carry passengers on or in any trailer.
- Always lock tail gate in the travel position before towing trailer.

LIGHTING

- Check all lights before each use and every 100 miles (160 km). REPAIR OR REPLACE ANY BROKEN LENSES, BULBS OR REFLECTORS.
- Check wires for good connections and possible fraying or wearing of insulation.
- Bulbs supplied with this trailer are for 12 volt system.
- Bulbs used in tail lights are: Number -1157-Stop/Turn and Tail.
- Bulbs for running lights are: Number -1895.

SAFE USE AND OPERATION RULES

WHEELS AND TIRES

- Check tire for wear, damage and proper inflation before each use and every 100 miles (160 km).
- Tire pressure should be kept at 80 PSI (552 kPa).
- Check and tighten lug nuts. Tighten to *85-90 ft-lb. (115.24 - 122.02 Nm)* of torque.
- **Retighten after first 25, 50 and 100 miles (40, 80, 160 km) and before towing each time thereafter.**

OPERATION

- Know how to properly control your towing vehicle-trailer combination on the highway under all conditions. It is important to remember that the loaded weight of the trailer will increase your braking and stopping distances appreciably.
- When towing a trailer over long distances, stop and check tightness of all connections, lights and running gear every 100 miles.
- Carry emergency flares, and fire extinguisher if required for operation in your state.
- It is desirable to carry extra bulbs and fuses if you are towing the trailer at night.

FOLDING THE TRAILER

WARNING! *Make sure your trailer is in a safe flat location and chock both tires before folding or unfolding.*

Step 1

Remove the two sets of nuts and bolts that secure the trailer bed halves together

Step 2

Remove the four sets of nuts and carriage bolts from the left and right spring hangers.

Step 3

Fold the rear section of the trailer over top of the front section.

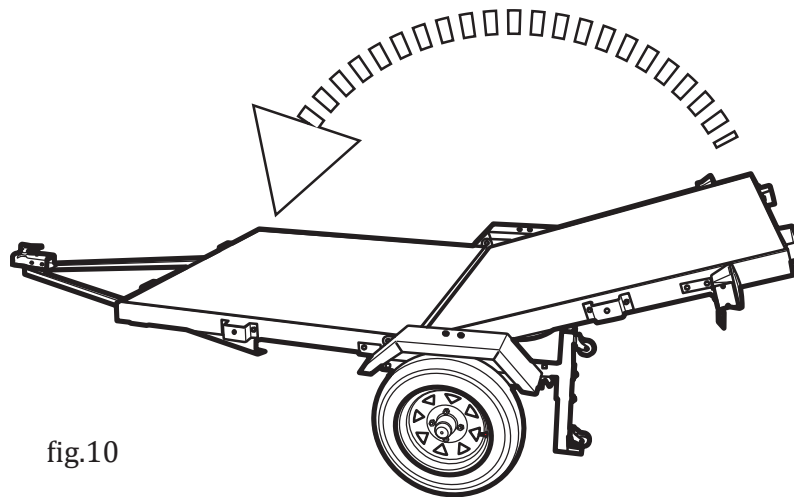

fig.10

Make sure you get the assistance of 1 or 2 additional people.

SAFE USE AND OPERATION RULES

Step 4

Secure the sections together using a bungee or rope. Make sure the trailer cannot open up while tipping onto castors for storage.

Step 5

Remove the wheel chocks from the trailer tires and tilt the trailer onto its casters (fig.11).

Make sure you get the assistance of 1 or 2 additional people. Do not try this on your own.

Step 6

Be careful when transporting trailer on caster wheels. The trailer can tip if you aren't careful balancing the weight.

Make sure you get the assistance of 1 or 2 additional people.

Step 7

The trailer is now ready to store against a wall. It is recommended you secure the trailer to avoid any movement while stored.

MAINTENANCE

- Check and maintain the trailer, coupler, ball and hitch before each use and every 200 miles (322 km).
- Inspect coupler, hitch and ball for damage before each use.
- Ball or hitch can be damaged in parking, hitting curbs, dragging when crossing ditches or railroad tracks.
- Check safety chains and hooks for wear and do not allow safety chains to drag on ground.
- To prevent bearing damage, disassemble and repack wheel bearing with a good grade of wheel bearing grease every 2000-3000 miles (3200 - 4800 km) or yearly.
- If you do not know how to repack wheel bearing, take your trailer to a qualified technician.

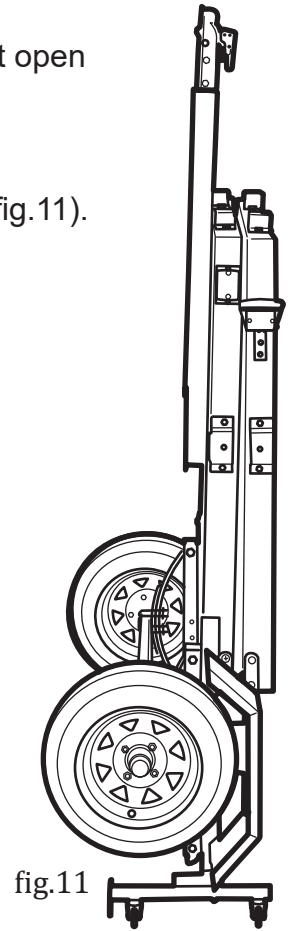

IMPORTANT: *The purpose of the following notices is to give you tips on safe use and operation of your utility trailer.*

1. **PLEASE READ** the instructions carefully and follow them step-by-step for easy assembly. Please keep this instruction.
2. **PLEASE DOUBLE CHECK THE ASSEMBLY** step-by-step to be sure each is followed.
3. **BEFORE USING, PLEASE INSPECT** your trailer.
4. **DO NOT REMOVE THE VIN STICKER** from the tow bar.

LICENSING

NOTICE:

- *Re-pack wheel bearings after every 3000 miles (4800 km) of use.*
- *Keep tire pressure at 80 PSI (552 kPa) with tires at ambient temperature.*
- *Please insure you comply with the following before using your trailer.*
 1. Tighten U-bolts
 2. Tighten wheel lug nuts.
 3. Coupler is secured to the ball and is properly adjusted.
 4. Cross and connect safety chains.
 5. Trailer load must not exceed its 1450 lb. (657.7 kg) capacity and must be properly secured.
 6. Trailer load size must not exceed trailers bed board size.

CANADIAN TRAILER LICENSING NOTICE

Some provinces may consider that this trailer is specially constructed or a homemade vehicle for registration, licensing and/or titling purposes.

When licensing your trailer, you will need the signed NVIS form, a purchase invoice, cash register receipt, or bill of sale showing the purchase and retail sales tax collected by the seller.

Take these to your local Provincial Ministry of Transportation Office and upon payment of the appropriate fees, you will be issued a title, registration, and license plate (if required). Some provinces will require inspection of the assembled and finished trailer kit before issuing a title registration/license.

If you require additional information or guidance on licensing or titling, please consult your Provincial Department of Motor Vehicles.

U.S.A TRAILER LICENSING NOTICE

Some states may consider that this trailer kit is specially constructed or a homemade vehicle for registration, licensing and/or titling purposes.

When licensing your trailer, you may need the signed M.C.O., a purchase invoice, cash register receipt, or bill of sale showing the purchase and retail sales tax or use tax collection by the seller. Take these to your local Department of Motor Vehicles and upon payment of the appropriate State fees, you will be issued a title, registration and license plate (if required). Some states will require inspection of the assembled and finished trailer kit before issuing a title registration/license.

If you require additional information or guidance on licensing or titling, please consult your State Department of Motor Vehicles.

PARTS LIST

ENGLISH

Item N ^o .	Description	Qty.
1	Safety chain	1
2	2" coupler	1
3	Towbar T-plate	1
4	Coupler base	1
5	Tow bar	2
6	Axle fish plate	2
7	Axle	1
8	3-leaf spring	2
9	U-bolt M10 x 85	4
10	Grease seal	2
11	Bearing 30205	4
12	Hub assy.	2
13	5.3-12" tire and wheel	2
14	Flat washer	2
15	Castle nut	2
16	Lug nuts	10
17	Cotter pin	2
18	Dustcap	2
19	Left spring hanger	1
20	Hex bolt M12 x 80 8.8G	6

Item N ^o .	Description	Qty.
21	2" caster	4
22	Left caster bracket	1
23	Right caster bracket	1
24	Fender bracket	2
25	Fender	2
26	Front bed	1
27	Inside hinge	2
28	Outer hinge	2
29	License plate bracket	1
30	Tail light	2
31	Rear bed	1
32	Tow bar connect hanger	2
33	Light holder	2
34	Bolt M10 x 20 8.8G	60
35	Carriage bolt M10 x 25 8.8G	4
36	Bolt M10 x 30 8.8G	4
37	Hitch pin Ø12 x 75 w/ R clip	2
38	Side marker	2
39	Bolt M12 x 25 8.8G	1
40	Stake pocket	8
41	Right spring hanger	1

SCHEMATIC DIAGRAM

HS17GN1

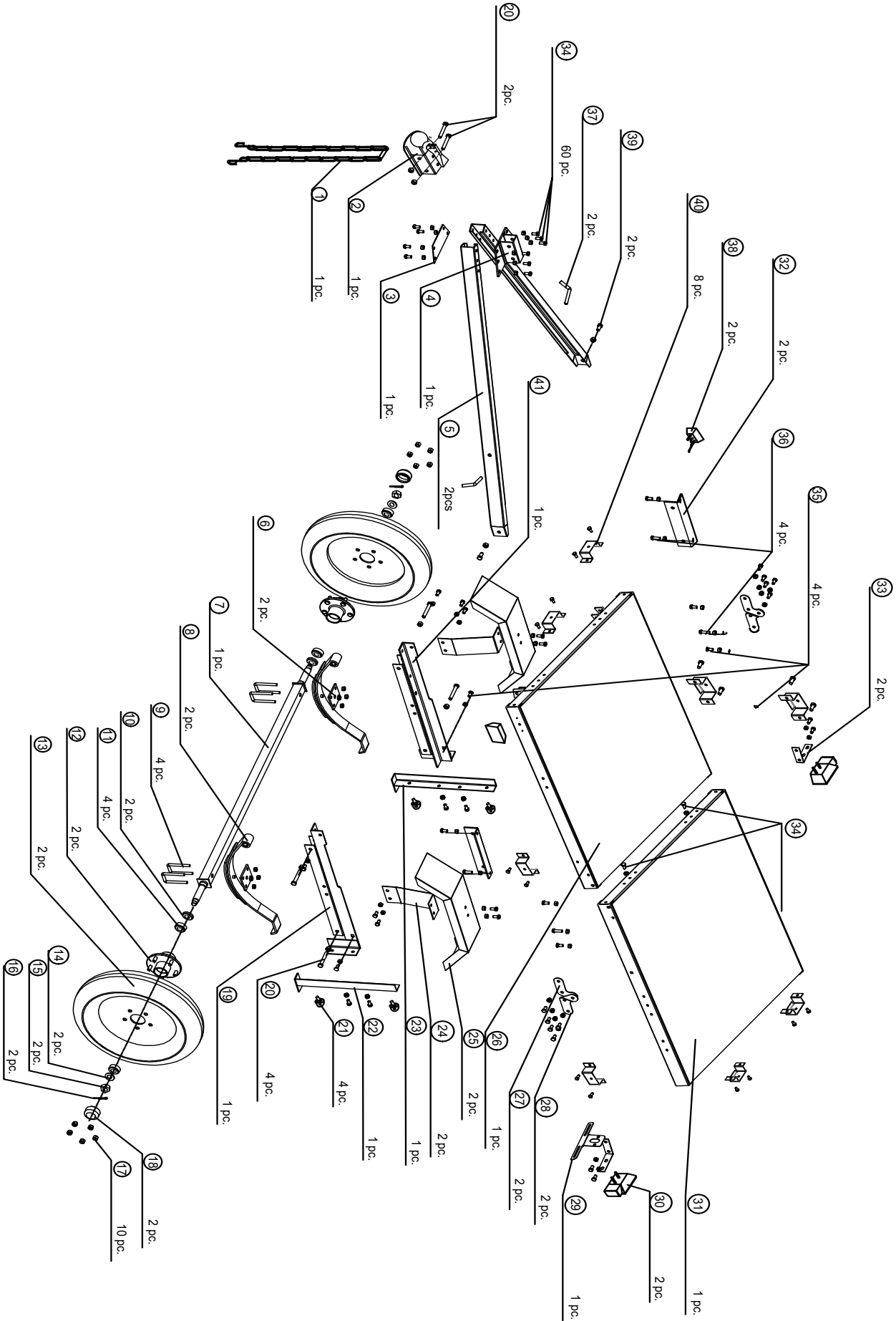

This page intentionally left empty.